

VESTA™ DEFENSE PDW50

CO2 semi-auto cal.50 defense pistol

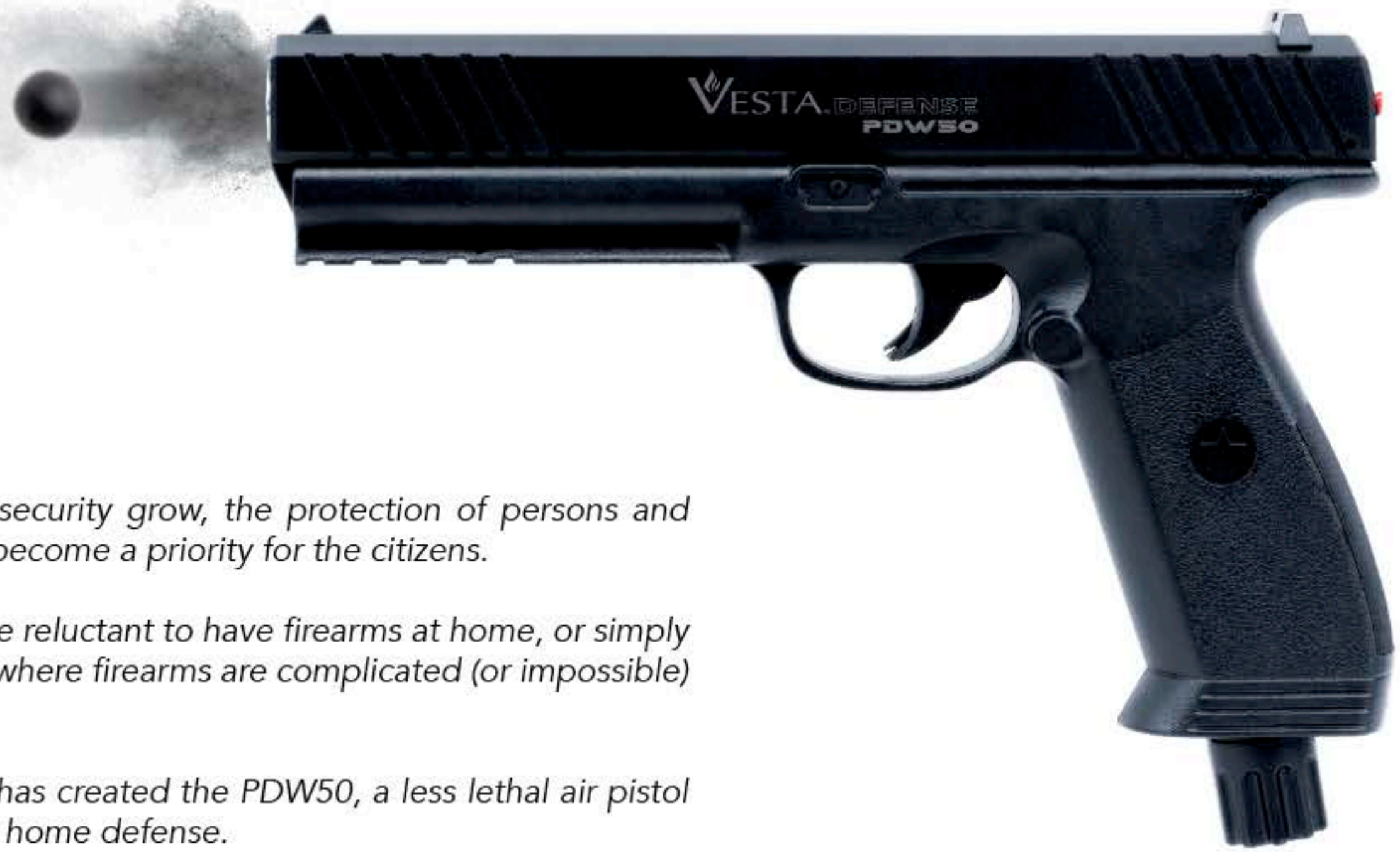



As crime and insecurity grow, the protection of persons and belongings has become a priority for the citizens.

Many of them are reluctant to have firearms at home, or simply live in countries where firearms are complicated (or impossible) to possess.

VESTA Defense has created the PDW50, a less lethal air pistol for personal and home defense.

Easy and safe to use even for non-shooters

Ready to fire in a flash thanks to the quick punch

Sturdy shock-absorbing structure

Trigger safety to prevent unintended shots

Smooth-edged user-friendly polymer shell

SPECIFICATIONS

The PDW50 is a simple operation and no maintenance weapon. However, it has been designed for optimal efficiency and user safety, thanks to these features.



Operation mode	CO2 semi-automatic
Slide type	Fixed
Capsule type	12 grs
Caliber	.50
Projectile type	Spherical
Magazine capacity	6
Power	~11 joules
Overall length	219 mm
Width	28 mm
Height	164 mm
Weight	480 grs
Rail type	Picatinny 5 dents
Trigger system	Double action
Safety	Trigger safety
Structure material	All metal
Shell material	Smooth-edged polymer

FEATURES



Quick punch device

The user can insert the CO2 capsule and leave it there without punching it. When the time has come, a solid smack will pierce the capsule open and the gun is immediately ready to shoot.



Trigger safety

Because the PDW50 is meant for non-shooters, unintended shots are a legit concern. The trigger safety solves this issue. No more accidental shots risk.



Pressure indicator

Conveniently located at the back of the slide, this little dot shows if the gun is ready to shoot or if the CO2 capsule must be replaced.



Integrated magazine

Instead of a separate clip that might jam or take time to insert, the PDW enjoys a built-in 6 round mag, located under the barrel. It can be kept loaded until shooting is needed.



Picatinny rail

Because you might have to use your gun in the dark, the integrated Picatinny rail allows to mount a laser or a flashlight. 5 dents ensure you that all Mil-Spec accessories fit. Users can even consider mounting a camera, in case they want to keep a trace of what happened during action.

INTERNALS

Although the shell of the PDW is made of polymer, for user's easy and pleasant handling, all the internals parts are made of metal: slide's inner frame, trigger and safety, barrel, CO2 fueling system, quick punch device. This ensures PDW50's sturdiness and reliability.

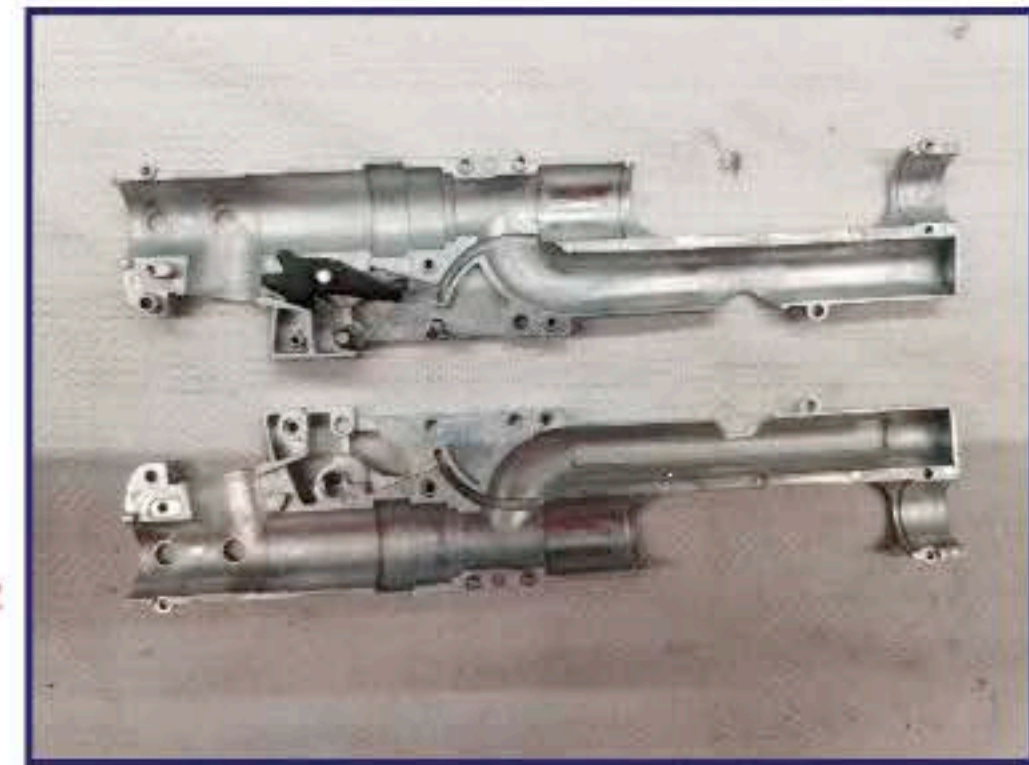
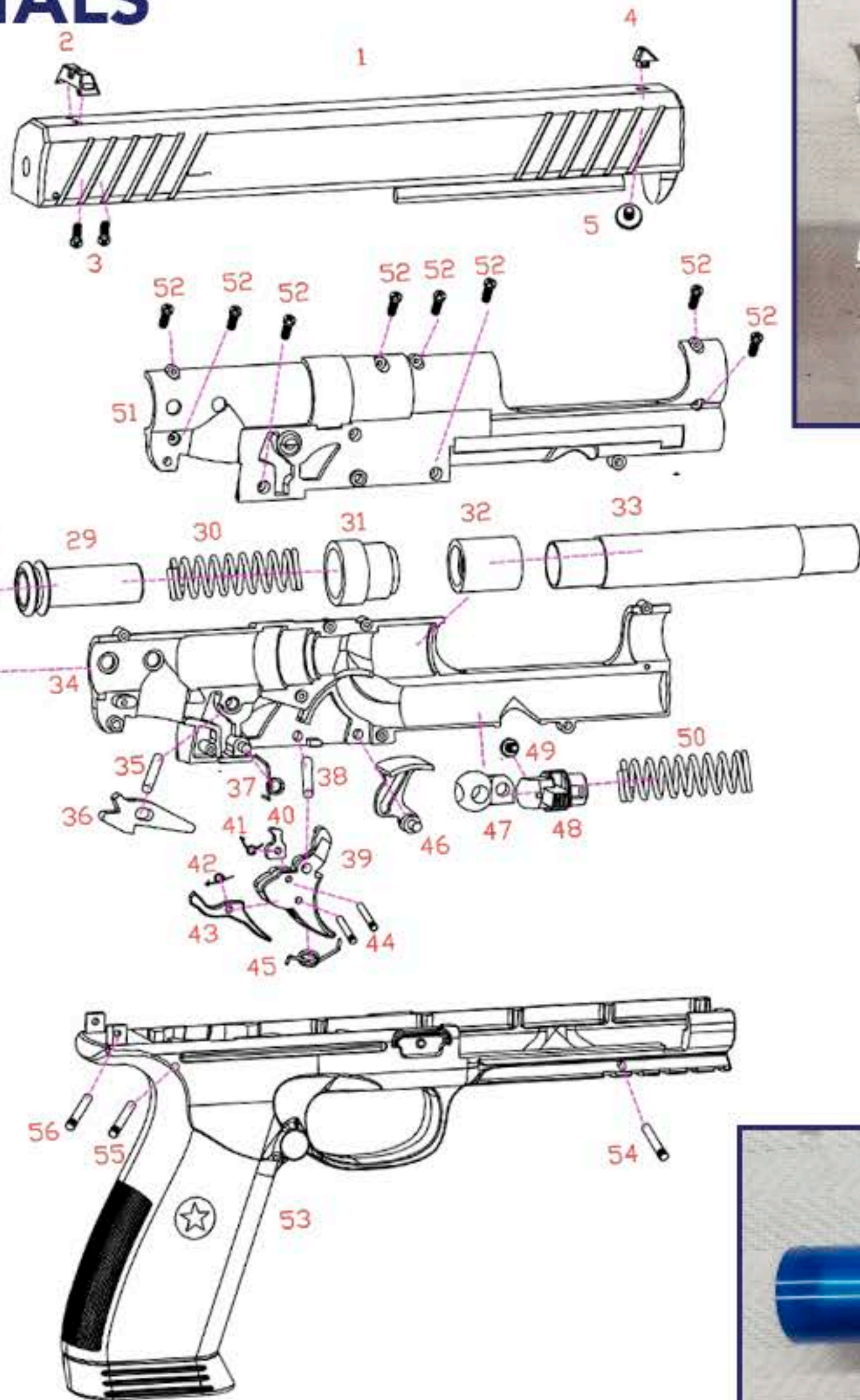

Metal inner slide's frame



Metal trigger with safety



CNC metal barrel

AMMO



PDW50's versatility allows shooting multiple ammo types: rubber, powder-based, polymer, metal, dye, combo. Each ammo has its specific use and relevance according to user's needs.



Type: rubber ball
Material: TPE rubber
Hardness: 098 HA
Color: black
Diameter: .50
Weight: 1.20 grs
Effect: kinetic impact
Used for: defense, training
Pack: jar of 100, jar of 50



Type: pepper ball
Material: OC 2%
Shell: crystal or cloudy
Color: red/white
Diameter: .50
Weight: 0.85 grs
Effect: pepper spray
Used for: defense
Pack: tube of 10, jar of 50



Type: steel core ball
Material: steel x polymer
Color: silver
Diameter: .50
Weight: 4.8 grs
Effect: high kinetic impact
Used for: defense, training
Pack: jar of 100, jar of 50



Type: chalk ball
Material: calcium carbonate
Shell: crystal or cloudy
Color: blue/white
Diameter: .50
Weight: 0.75 grs
Effect: chalk stain
Used for: training, fun
Pack: jar of 100, jar of 50

more ammo in development...



Type: special polymer
Weight: 1.4 grs
Long-range reach



Type: permanent dye
Weight: 1.2 grs
Glow in the Dark



Type: chili ball pava 4%
Weight: 0.85 grs
The strongest pepper effect



Type: aluminium
Weight: 2.9 grs
Affordable



Type: chrome-plated steel
Weight: 8.4 grs
Friction-resistant



Type: nickel-plated steel
Weight: 8.4 grs
Hi-kinetic performance



Type: brass
Weight: 9.1 grs
The heaviest

VERSIONS



V1 - All Black
Full power <12 j
Item n°452.9211.00



V2 - Orange slide
Full power <12 j
Item n°452.9211.01



V3 - All Black
Power <7.5 j
Item n°452.9211.02

in development...

PDW50
ULTRA
<16 joules



SIERRA Stabilizer
in collabration with RECOVER tactical





VESTA Defense is a Department of PLAN BETA Ltd

HQ: 6 Wang Kwun road, Kowloon Bay, HONG KONG SAR
Commercial office: Route de Sainte Suzanne, 27160 Breteuil, FRANCE

E-mail: vestadefense@planbeta.net
www.vestadefense.com